

GN 709.15

Clamping pads

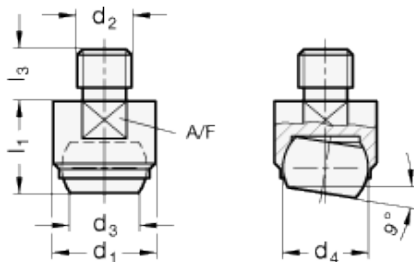

INOX
Stainless Steel



Application example
when used as a
workpiece support

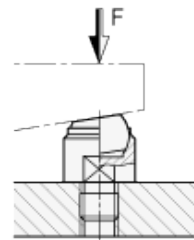

technical informations

Material

AISI 431 tempered stainless steel.

Ball

AISI 420C stainless steel, nickel-plated.

Standard versions available

- Version B: smooth contact face.

Special executions on request (For sufficient quantities)

Serrated hard metal ball.

Features and applications

Stainless Steel-Clamping pads GN 709.15 are used as mobile supports or as spring plungers for clamping workpieces. They can also be used as a back stop.
The ball is limited to an angular movement of 9° only.

Standard Elements	Main dimensions							Static load max. in kN	Weight
Description	d ₁	d ₂	d ₃	d ₄	l _{1±0.02}	l ₃	A/F		g
GN 709.15-13-M6-B	13	M6	7.2	10	13	8	11	10	13
GN 709.15-13-M8-B	13	M8	7.2	10	13	8	11	10	20
GN 709.15-20-M8-B	20	M8	10.5	16	18	10	17	25	38
GN 709.15-20-M10-B	20	M10	10.5	16	18	10	17	25	40
GN 709.15-20-M12-B	20	M12	10.5	16	18	12	17	25	43
GN 709.15-30-M16-B	30	M16	20	25	27	16	27	90	150
GN 709.15-50-M20-B	50	M20	34.5	40	35	20	41	165	488



STANDARD MACHINE ELEMENTS WORLDWIDE